



20th March - 15th April
Toscana
2012TOUR

132

Class No.

Silver Tour

Competition in two Phases

7. April 2012

Start: 8:00

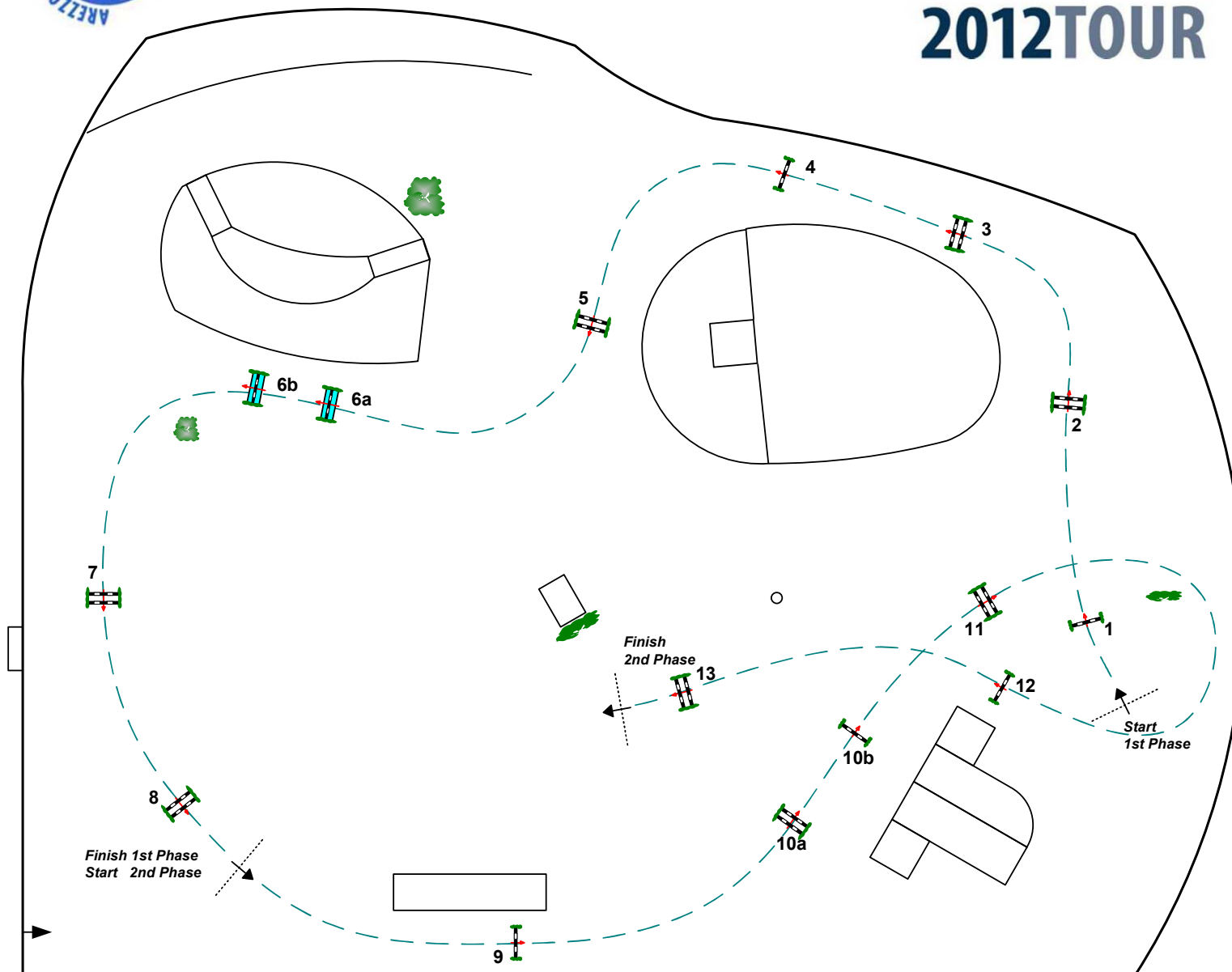

Table: A

FEI RG / Art. 274-5.3
Height: 1.40 m

Speed: 350 m/min

Length: 270 m
Time allowed: 47 sec
Time limit: 94 sec

Obstacles: 8
Efforts: 9
Penalty sec
Closed combination:

2nd Phase:
9-10a-11-12-13

Length: 210 m
Time allowed: 36 sec
Time limit: 72 sec

Course Design: Rolf Lüdi SUI
Elio Travagliati ITA
Gérard Lachat SUI

