



CSI 2* / CSI 1* YH Eschweiler

Masters 26.-29.04.2012

09

Class No.: **04**

Medium Tour

Competition in two Phases

Freitag, 27. April 2012

Start: 12:00

Table: A
National RG:
FEI RG / Art. 274.5.3
Height: 1,30 m

Speed: 375 m/min

Length: 290 m
Time allowed: 47 sec
Time limit: 94 sec

2nd Phase:

9-13
Length: 200 m
Time allowed: 32 sec
Time limit: 64 sec

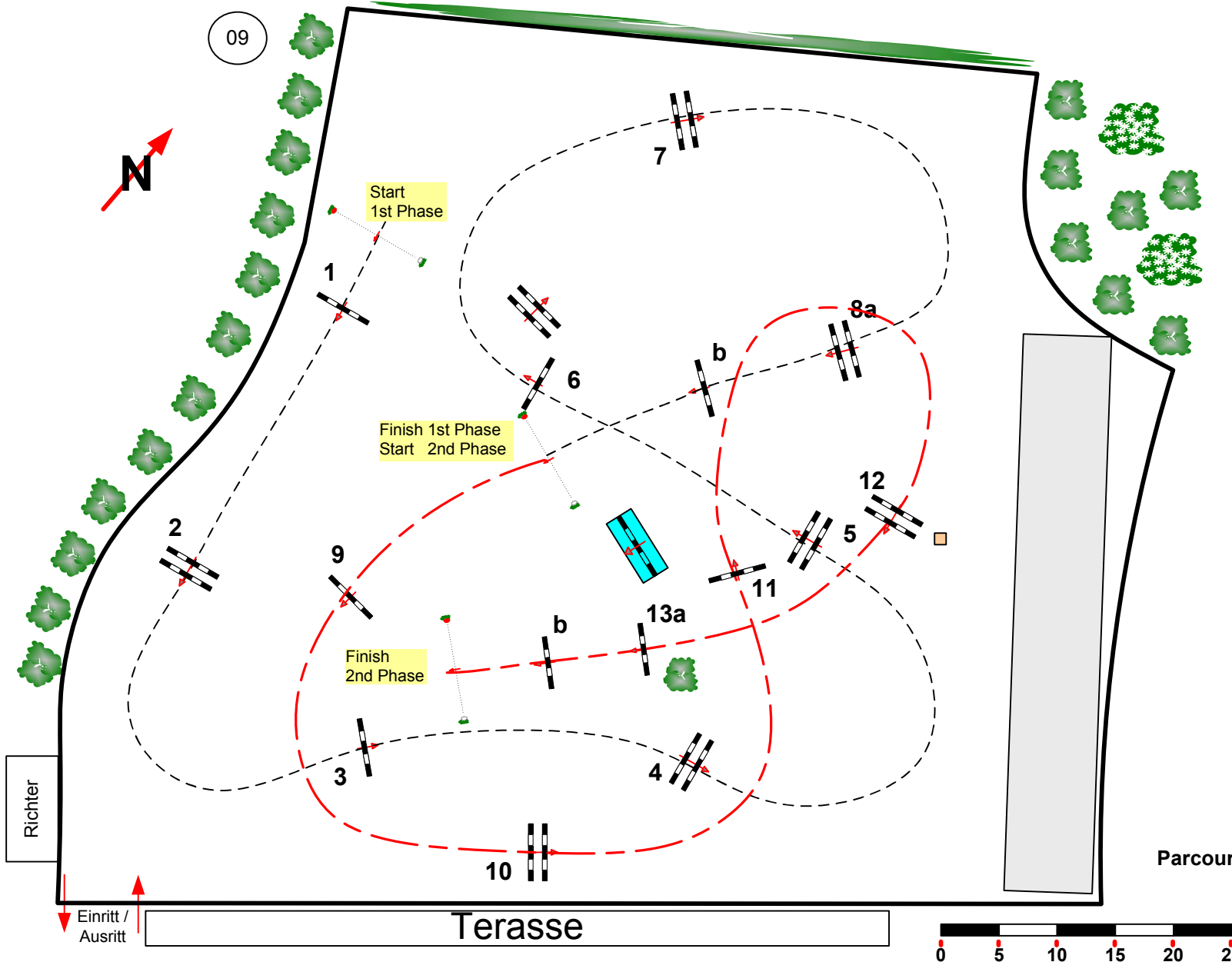

Parcourschef: Arno Gego, Aachen/GER