



# Ocala - CSIO 4\* 2015

Ocala Horse Properties Stadium



SUNDAY

Jury

## Ocala Grand Prix

FORMAT:  
JUMP OFF

FEI RG: II.2.B  
HEIGHT: 1,60 M

SPEED:  
375 M/MIN

LENGTH:  
0 M  
TIME ALLOWED:  
0 SEC  
TIME LIMIT:  
0 SEC

OBSTACLES: 12  
EFFORTS: 15

JUMP OFF:  
-13-15-9A-9B-8-16-11-

LENGTH:  
270 M  
TIME ALLOWED:  
44 SEC  
TIME LIMIT:  
88 SEC

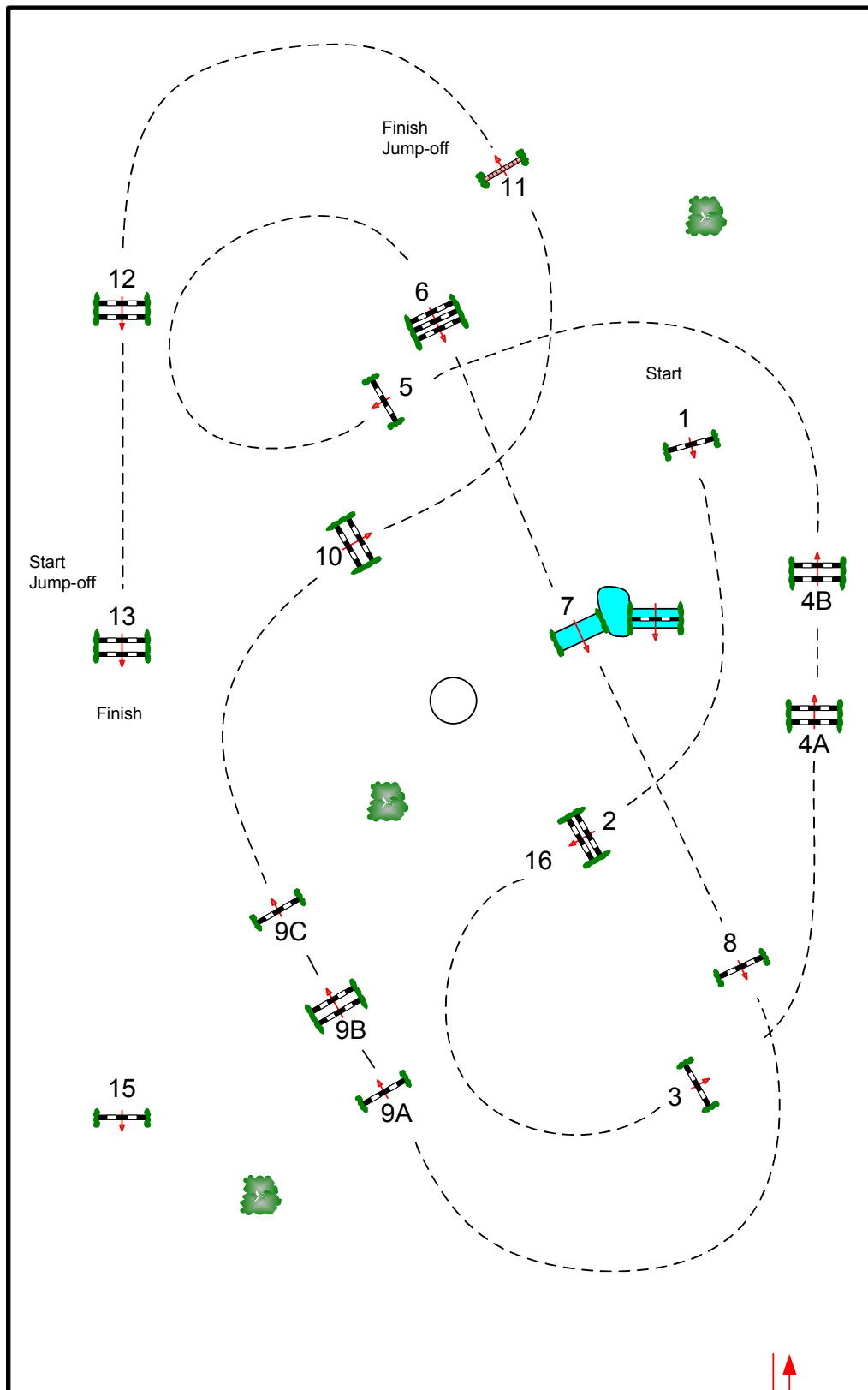

In / Out ↑ ↓

COURSE DESIGNER MARTIN OTTO / GER

